

MOUNTING OF LITEX BOARD on walls

Litex Board: The Litex Board is a vapour-proof membrane panel ready for the laying of tiles in bathrooms and wet rooms. Membrane must **NOT** be applied to them. Litex Board are supplied in sizes 60x244 cm with thicknesses of 13, 20, 30, 50 and 75 mm. Weight per board:

- 13 mm 1.8 kg
- 20 mm 2.4 kg
- 30 mm 2.9 kg
- 50 mm 3.8 kg
- 75 mm 5.3 kg



Mounted vertically or horizontally on walls.

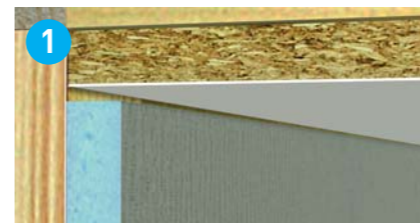

Distance to ceiling and adjacent walls - minimum 5 mm clearance.



Alternatively, screw fastenings in the middle of the board can be replaced by spot adhesive so that only joints may be sealed.

Base	Fastening screw length	Board thickness and screw distance
• Fixed substrate (close boarding etc.)	Litex thickness + close boarding + 5 mm	<ul style="list-style-type: none"> • 13 mm Litex Board: 25 cm at board joints + 3-4 screws with disk across middle of board. • 20 mm Litex Board: 30 cm at the joints. • 30 mm Litex Board: 40 cm at the joints.
• Wooden studding	Litex thickness + 20 mm	<ul style="list-style-type: none"> • 13 mm Litex Board: 25 cm at board joints + 3-4 screws with disk across middle of board. • 20 mm Litex Board: 30 cm at the joints. • 30 mm Litex Board: 40 cm at the joints.
• Steel studding	Needle-point screws in Litex thickness + 5-10 mm	<ul style="list-style-type: none"> • 13 mm Litex Board: 25 cm at board joints + 3-4 screws with disk across middle of board. • 20 mm Litex Board: 30 cm at the joints and middle of board and at top and bottom. Screw successively from bottom to top or vice versa.

På annet underlag se: www.litex.no/monteringsanvisning

SEALING OF JOINTS

Opt. 1: Litex Jointing Tape Self-Adhesive

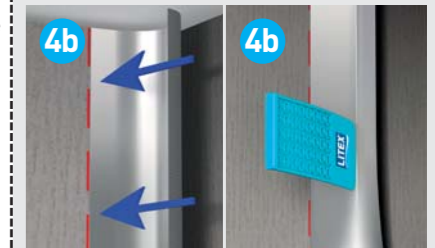
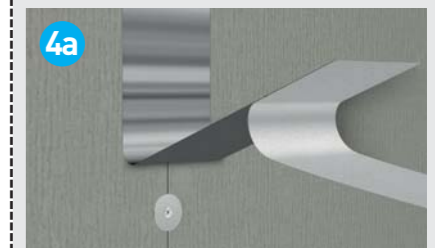

Litex is used on wall joints, in wall corners and screw fixings (Jointing Tape Self-Adhesive must **NOT** be used at the transition between walls and floors).

Liquid membrane must not be used on the self-adhesive tape.

- **The recommended room and tape temperature during installation is above 15°C.**
- Ensure the tape contains no air bubbles and that there are no loose corners prior to laying tiles.
- Use a plastic ice scraper, for example, or preferably a corrugated roller to secure the tape firmly.
- Prevent dust in the room during installation.

Opt. 2: Litex Jointing Strip Fibre or Litex Jointing Tape Rubberised

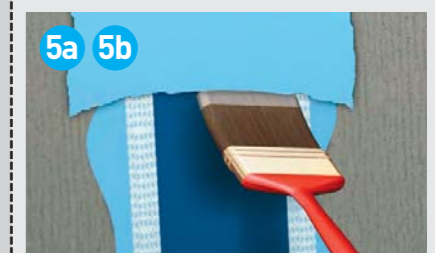

If **Litex Jointing Strip Fibre** or **Litex Jointing Tape Rubberised** is used for joints and screw penetrations, these must be mounted wet-on-wet with liquid membrane. Apply the membrane over the joint and ensure there is an overlap to the seal. **Litex Jointing Tape Rubberised** is recommended in wet rooms.

6 TRANSITION BETWEEN WALL AND FLOOR

Litex Corner Pieces can be mounted to the Litex Board with Litex Mounting Adhesive and coated with liquid membrane.

Litex Jointing Tape Rubberised is used in transitions between floors and walls and in areas subject to high water contact. It is installed wet-on-wet with liquid membrane. Brush liquid membrane over the joint or penetration, press down the tape to wet it thoroughly and coat with liquid membrane. Remember to let the vertical jointing strip overlap the horizontal transition by 20 mm. Apply Litex Jointing Tape Rubberised with an overlap to Litex rubberised corner pieces. Litex Jointing Tape Rubberised must overlap vertical Jointing Tape Self-Adhesives by 20 mm. Remember that moulded floors should be primed prior to sealing to the floor.

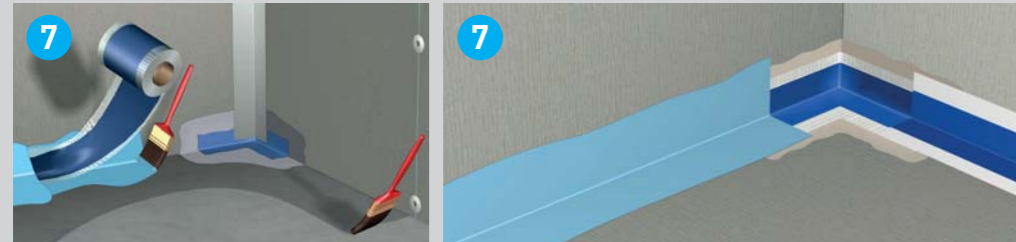

8 PIPES/TILES

Holes for pipes/drains: Accurately measure up the positions and sizes of pipes and drains. Hold the Litex Board against the pipe stub and hammer on the board. Cut along the impression with a jigsaw, hole-making tool or utility knife.

Pipes/drains: Pipe entries with pipe-in-pipe systems are fitted so the sleeve penetrates 1-2 mm outside the fully installed tile. The Litex pipe sleeve is glued to the Litex Board with Litex Mounting Adhesive. Press the sleeve on and brush or roll the surface so the sleeve is in complete contact with the mounting adhesive. Once the adhesive is dry to the touch, cover the sleeve with liquid membrane.

Tiled walls: Cover the mounted Litex Boards with tiling adhesive and tiles. To avoid drilling through tiles for mounting towel holders and other light objects, you could try Litex Mounting Adhesive.

11 WALL-MOUNTED TOILETS

The **mounting frame** for a wall-mounted WC is fitted over the finished Litex wall. The Litex Board are glued directly to the wall frame using Litex Mounting Adhesive. Litex 20 mm is used for the mounting frame, max. c-c 60 cm. Fully install the WC in accordance with the manufacturer's instructions. Wall-mounted WCs must be placed in front of the full-cover membrane in order to minimise any damage in the event of leaks.



Prepare the reinforcements by making a cut at the points of contact between the cross member and the porcelain. Cut out a square 2 x 2 cm and fill with tiling adhesive/cement. The points of contact will vary according to WC type and frame. The stippled line shows the outline of the WC.

The reinforcement is filled with tiling adhesive or cement.

Cut a drainage slot at the transition between the floor and the board to ensure that any leaks are discovered.



Installation instructions for LITEX® Wet Room System **ON-FLOOR**

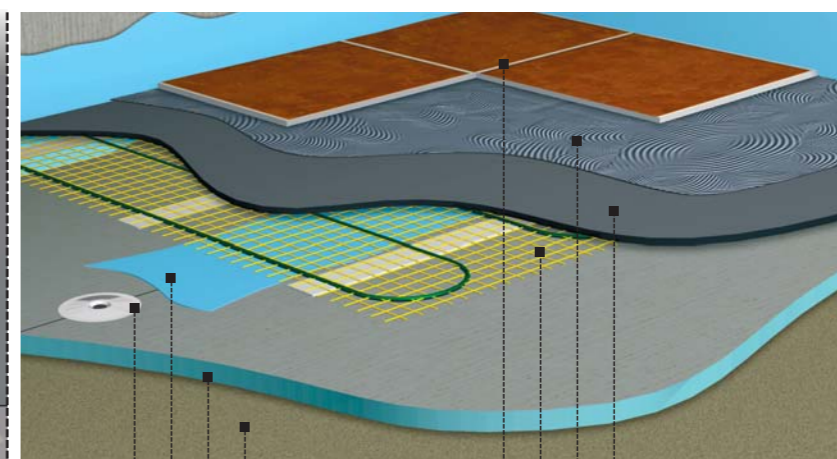
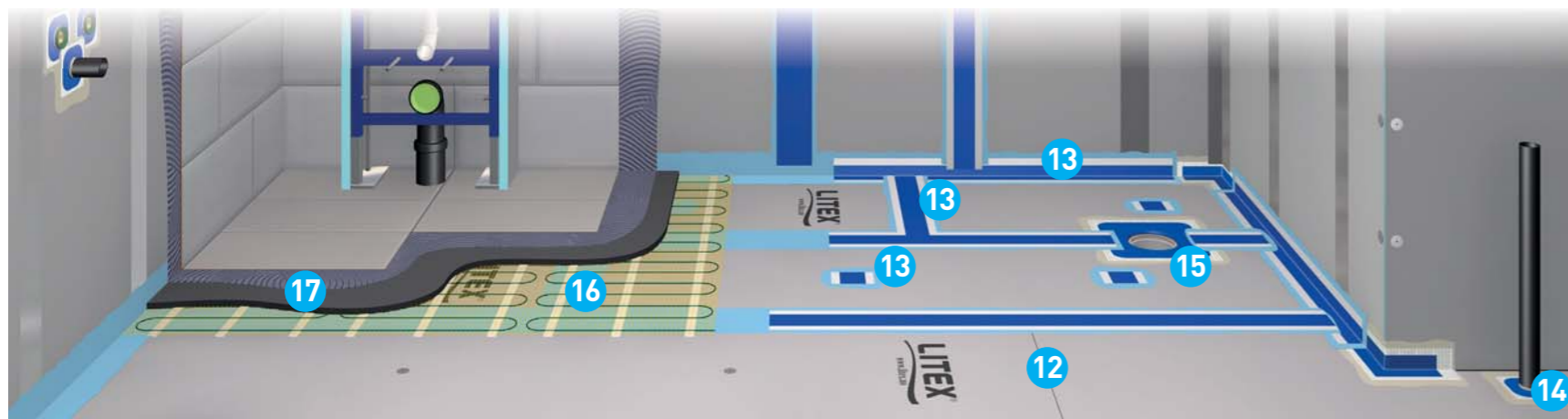

LITEX PRODUCTS:

Litex Membrane Boards

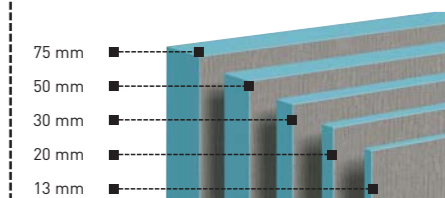

Litex Corner Piece

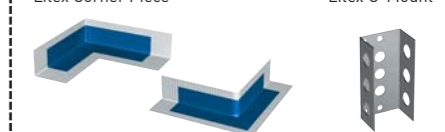

Litex Pipe Sleeve



Litex Jointing Tape Self-Adhesive



Litex Screw

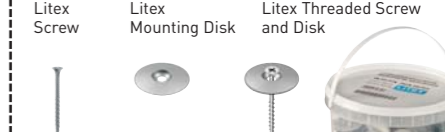

Litex Grooved Roller



LITEX MOUNTING on floors

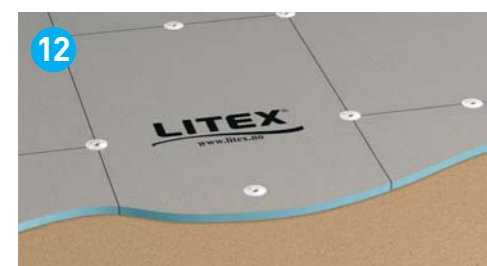

Litex mounted on floors requires full support and a stable substrate. A minimum Litex thickness of 20 mm is recommended on floors. It is recommended that any falls are laid in the sub-floor. The Litex Board are vapour-proof and no further vapour barrier in the form of a plastic or liquid membrane is necessary.

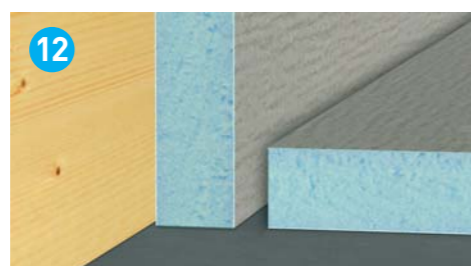

The boards are laid on wooden floors, but allow a minimum 5 mm gap from the wall. Screw the boards to the floor with Litex Mounting Disks and screws. Screw at intervals of 250 mm along the joints and use 4-5 screws in the middle of the board. Screw length = Litex thickness + 25 mm. Over large surfaces, mount the boards with 600 mm offsets. In rooms with floorboards, the boards should be mounted across the floorboards with 600 mm offsets.

On concrete floors the Litex Board should be glued to the floor using Litex Mounting Adhesive, tiling adhesive or low-expanding foam adhesive. The concrete must be primed before installation. Fasten with 2-3 Litex screws with disks along the centre of the board.

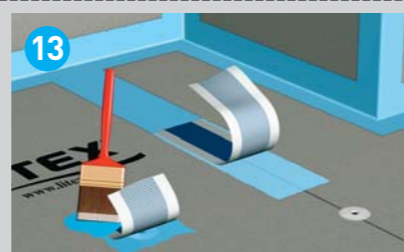

SEALING CORNERS AND TRANSITIONS

Prefabricated internal and external corner pieces should be glued with Litex Mounting Adhesive and coated with liquid membrane. Joints and screw penetrations should be coated with membrane. Then lay Litex Jointing Strip Fibre or Litex Jointing Tape Rubberised on the wet membrane and coat it well with membrane wet-on-wet. Remember to allow the vertical jointing strip to overlap the horizontal transition by 20 mm. Seal all transitions between wall and floor, joints, screw fixings and transitions between different materials with Litex Jointing Tape Rubberised and liquid membrane.

Litex Jointing Tape Rubberised is recommended for the transition between wall and floor and areas subject to high water contact, as it has considerably higher resistance to chemicals and detergents, better ageing resistance and better flexibility. Litex Jointing Tape Rubberised is also more flexible in relation to settlement and movement in building structure.

Remember to mount Litex Jointing Tape Rubberised to overlap the Litex rubberised prefabricated corner pieces.

UNDER-FLOOR HEATING CABLES

- Stable subfloor
- Most Litex thicknesses can be used
- Sealing of joints and screw penetrations
- Litex Mounting Disk
- Water-resistant moulding compound
- Tiling adhesive
- Heating cable up to 10 W per lm directly on Litex Board
- Tiles

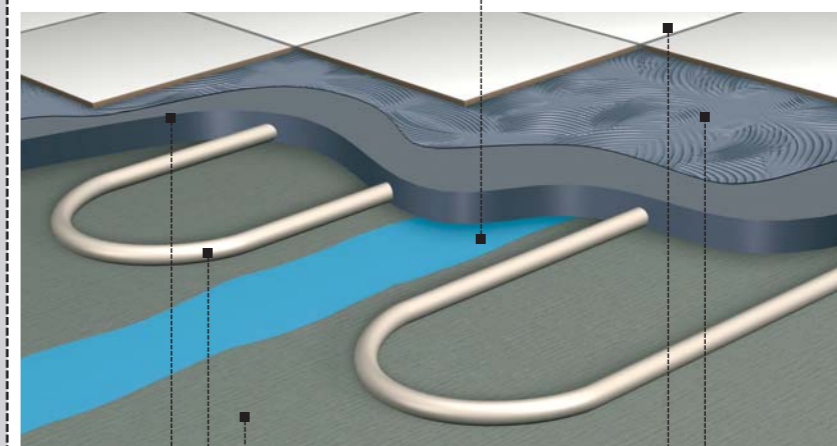

WATERBORNE HEATING

- Litex Board on stable subfloor
- Water pipes and any fixing brackets should be glued to the Litex Board with hot-melt adhesive. Seal water pipes with Litex Pipe Sleeve 8 mm and Litex Mounting Adhesive
- Lay moulding compound to give 12 - 15 mm cover over water pipes
- Tiling adhesive
- Tiles

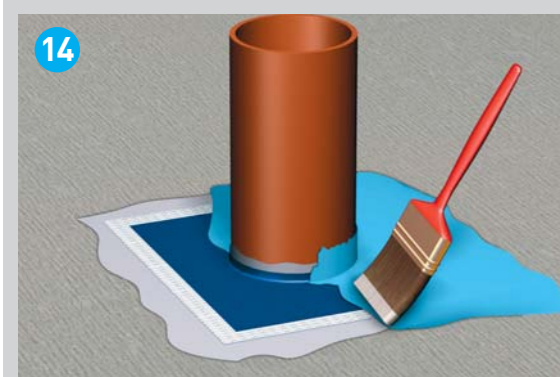

MOUNTING OF DRAINPIPE SLEEVE

Apply Litex Mounting Adhesive round the drainpipe with a scraper. Push on a Litex 65 mm pipe sleeve and press down the surface to ensure good contact between the sleeve and the adhesive. When the adhesive is dry, coat the sleeve with liquid membrane.

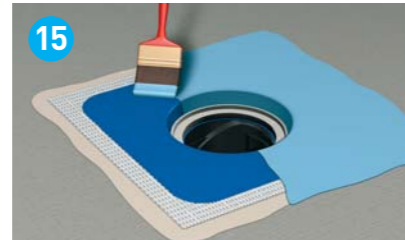
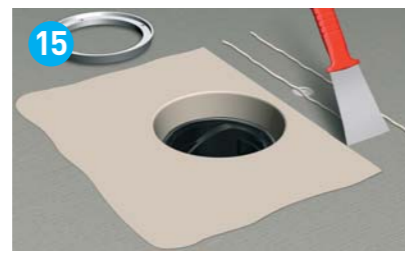
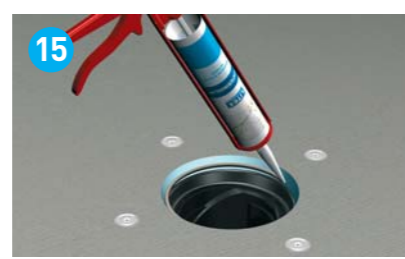

FITTING OF DRAINS

The drain can be fitted flush with the subfloor or the top of the Litex Board. Use Litex moulded drain sleeves for Joti/Pipeline and Serres Drains, together with Litex 20 mm Board. Here the drain must be flush with the subfloor. For other thicknesses of Litex or other drain types use Litex Drain Sleeve Universal or Litex 90 mm Pipe Sleeve. The board may be whole or divided round the drain. Most common drain types can be safely mounted together with Litex. Follow the manufacturer's instructions.

Gluing of drain sleeve: Position four screws with disks within the area covered by the drain sleeve. Remove the clamping ring and apply Litex Mounting Adhesive round the drain over an area approx. 2 cm larger than the drain sleeve. Spread out evenly. Lay the drain sleeve in the wet adhesive and smooth the adhesive over the sleeve reinforcement. Make sure the sleeve is well fixed to the adhesive. Apply adhesive under the sleeve down towards the O-ring and round the top of the drain. Press down the clamping ring and screw in place.

Sealing the drain sleeve: Allow the adhesive to dry while mounting the rest of the floor. Apply liquid membrane to the top of the drain sleeve and over an area approx. 2 cm outside the sleeve. Follow the manufacturer's instructions for mounting the drain.

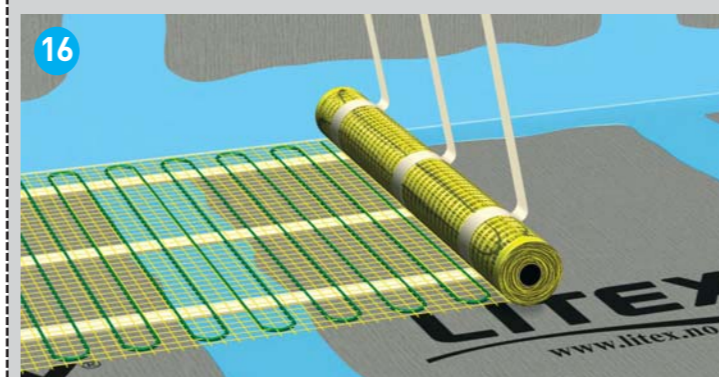

UNDERFLOOR HEATING CABLES DIRECTLY ON THE LITEX BOARD

Heating cables of up to 10 W per linear metre/80-120 W per square metre (operating temperature under 70°) can be laid directly on the Litex Board. The heating cables may be mat-based or loops taped or glued to the Litex Board. Heating cables should be mounted in accordance with manufacturer's instructions.

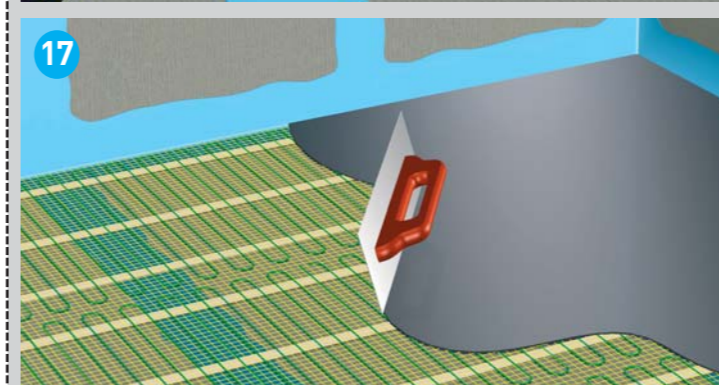

MOULDING COMPOUNDS

Use moulding compounds such as Hey'di Flytstøp, Laticrete Flytstøp, Weber Støpemørtel Bad or other low installation-height water-resistant compound. Use the compound in accordance with the manufacturer's instructions. In water contact zones in showers, the bathroom compound must always be coated with liquid membrane. Where traditional compounds and finishing coats are selected which are not water-resistant, these must be fully covered with liquid membrane. It is recommended that falls to the drain are formed in the subfloor. Remember to clean the substrate to ensure good adhesion.